

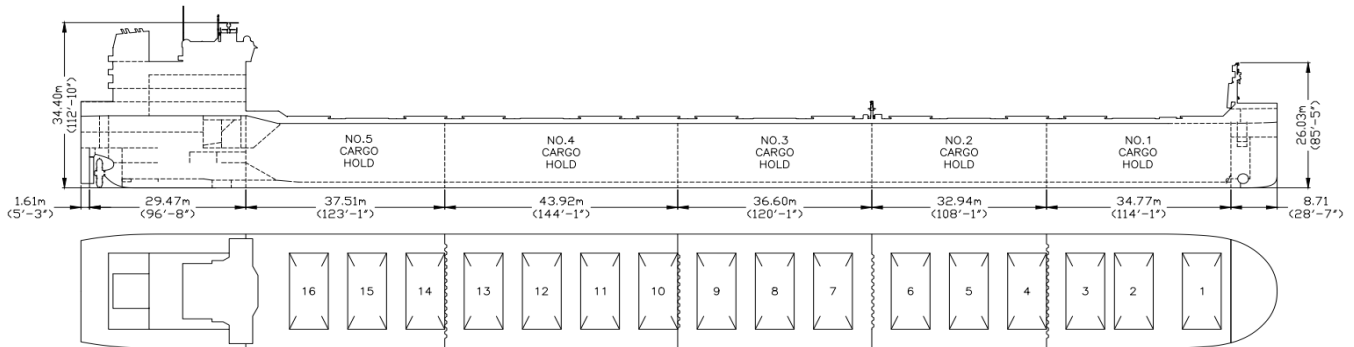

Captain Henry Jackman



Manager: Algoma Central Corporation
 Registry: Toronto / Canada
 Builder: Jiangsu Newuangzi Shipbuilding
 Type: Great Lakes Bulk Carrier
 Class: Lloyds Register of Shipping
 ✱100A1 Great Lakes & River St Lawrence

Principal Particulars

	Metres	Feet
LOA	225.54	740'-0"
LBP	223.92	734'-7 3/4"
Beam (mld)	23.77	77'-11 7/8"
Depth (mld)	13.40	43'-11 1/2"

Tonnage

	International
Gross	22777
Net	9553

Great Lakes Load Lines

	Metres	Feet
MS (FW)	8.866	29'- 1"
S (FW)	8.650	28'- 4 3/5"
INT (FW)	8.552	28'- 3/4"
W (FW)	8.454	27'- 8 7/8"
MS (SW)	8.651	28'- 4 3/5"
S (SW)	8.435	27'- 8"
INT (SW)	8.337	27'- 4 2/9"
W (SW)	8.239	27'- 3/8"

Cargo Deadweight

(Consumables Excluded)	Metric	Long
@ Mid Summer	35,378	34,821
@ 26'- 6" (FW) Seaway Draft	31,226	30,734

Note: Deadweight shown excludes Crew & Effects, Fuel Oil, Lube Oil, Water & Stores (~610 MT).

Hold Capacities (NET)

	m ³	ft ³
Hold 1	8,494	299,977
Hold 2	8,188	289,149
Hold 3	7,344	259,362
Hold 4	10,975	387,586
Hold 5	8,854	312,658
Total, holds and hatches	43,855	1,548,732

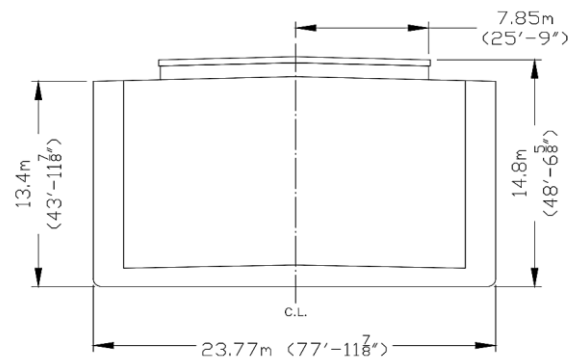

Midship Air Draft

(To Top of Hatch Coaming at Side)

	Metres	Feet
Summer (FW) (8.650 m)	6.150	20'-2"
Seaway (FW) (8.077 m)	6.723	22'-1/2"
Ballast (FW) (5.164 m)	9.636	31'-7 3/8"

Hatches

Number: 16	Length	Width
Type: Single plate	15.84m	7.32m
	Metres	Feet
Bow to mid Hatch #1	14.19	46'-6 5/8"
Fwd to Aft	168.36	552'-4 3/8"
Mid Hatch #16 to Stern	42.99	141'-1/2"