

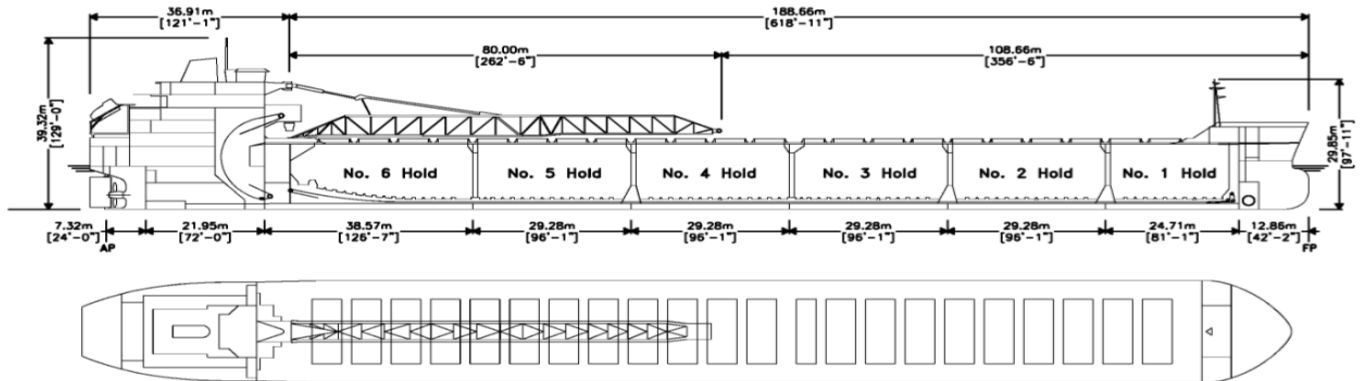

# Radcliffe R. Latimer

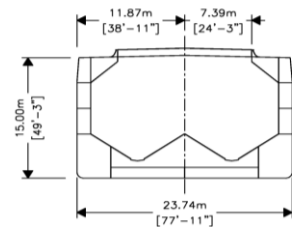

Manager: Algoma Central Corporation  
 Registry: Sault Ste. Marie / Canada  
 Builder: Collingwood Shipyards, 1978, Hull 215  
 Type: Great Lakes Self Unloading Bulk Carrier  
 Class: Lloyds Register of Shipping  
 ✱100A1 Great Lakes & River St Lawrence & Coastal, ESP notation



## Principal Particulars

	Metres	Feet
LOA	225.564 m	740' - 0"
LBP	220.12	722' - 2"
Beam (mld)	23.74 m	77'-10 <sup>5</sup> / <sub>8</sub> "
Depth (mld)	15.00 m	49'- 2 <sup>1</sup> / <sub>2</sub> "

## Tonnage

	Cdn	US
Gross	24,102	
Net	11,587	

## Assigned Drafts

	Metres	Feet
Tropical (SW)	10.623	34' - 10 <sup>1</sup> / <sub>4</sub> "
Tropical (FW)	11.078	36' - 4 <sup>1</sup> / <sub>8</sub> "
S (SW)	10.168	33' - 4 <sup>3</sup> / <sub>8</sub> "
S (FW)	10.623	34' - 10 <sup>1</sup> / <sub>4</sub> "
W (SW)	9.957	32' - 8"
W (FW)	10.412	34' - 1 <sup>7</sup> / <sub>8</sub> "

## Self Unloading Equipment

Two belt gravity system with loop belt elevator. 80.0 m discharge boom luffing to 18° and slewing to 95° P&S. Shear type basket gates, UHMW plastic linings in holds and vibrators throughout tunnels. Designed discharge rate of up to 5,440 metric tons/hour.

## Cargo Deadweight

(610 MT consumables assumed)

	Metric	Long
@ 10.15 m (FW)	37,257	36,668
@ 26'- 6" (FW) Seaway Draft	26,870	26,445

Note: Deadweight shown excludes Crew & Effects, Fuel Oil, Lube Oil, Water & Stores (~610 MT).

## Midship Air Draft

(To Top of Hatch Coaming at Side)

	Metres	Feet
Summer (FW) (10.168 m)	5.888 m	19' - 3 <sup>3</sup> / <sub>4</sub> "
Seaway (FW) (8.077m)	7.979 m	26' - 2 <sup>1</sup> / <sub>8</sub> "
Ballast (FW) (6.650 m)	9.406 m	30' - 10 <sup>3</sup> / <sub>8</sub> "

## Hold Capacities

	m <sup>3</sup>	ft <sup>3</sup>
Hold 1	4,807	169,757
Hold 2	6,742	238,091
Hold 3	6,668	235,478
Hold 4	6,742	238,091
Hold 5	6,742	238,091
Hold 6	7,587	267,932
Total, holds and hatches	39,288	1,387,440

## Hatches

Number:	22	
Type:	Single plate	
	<b>Metres</b>	<b>Feet</b>
Bow to mid Hatch #1	26.67	87.50
Fwd to Aft	153.62	504.00
Mid Hatch #22 to Stern	45.26	148.50

63 Church Street Suite 600 St. Catharines, Ontario L2R  
 3C4 Tel: 905.988.2600 Fax: 905.988.1801  
[www.algonet.com](http://www.algonet.com)