

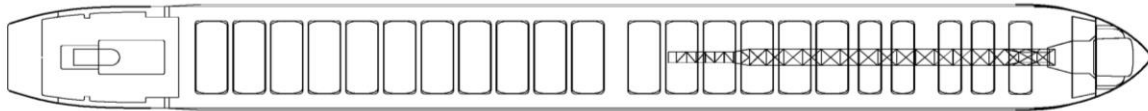

John D Leitch

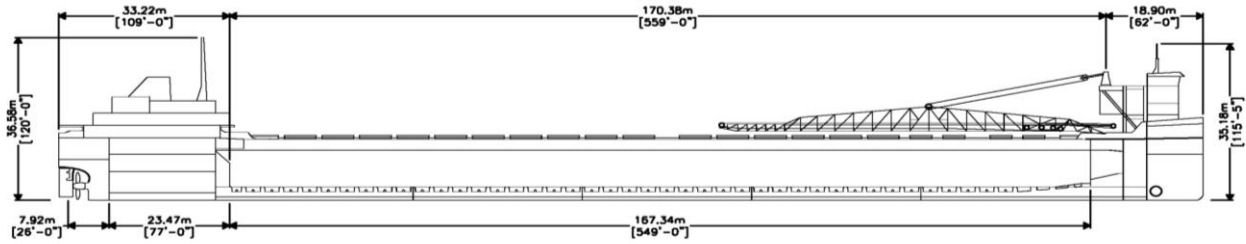

Manager: Algoma Central Corporation
 Registry: Toronto / Canada
 Builder: Port Weller Dry Dock, 1967, Hull 41
 Type: Great Lakes Self Unloading Bulk Carrier
 Class: Lloyds Register of Shipping
 ✕100A1 Great Lakes & River St Lawrence service ✕LMC

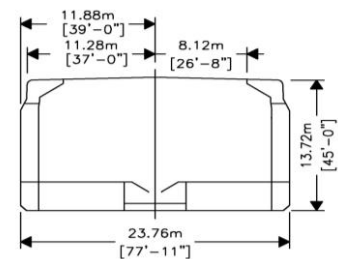

Principal Particulars

	Metres	Feet
LOA	222.50 m	730' - 0"
LBP	220.68 m	724' - 0"
Beam (mld)	23.76 m	77' - 11 3/8"
Depth (mld)	13.72 m	45' - 0"

Tonnage

	Cdn	US
Gross	22,080	20,031
Net	9,107	

Assigned Drafts

	Metres	Feet
Mid Summer (FW)	9.242	30' - 3 7/8"
Mid Summer (SW)	9.032	29' - 7 5/8"
Summer (FW)	9.017	29' - 7"
Summer (SW)	8.807	28' - 10 3/4"
Intermediate (FW)	8.679	28' - 5 5/8"
Intermediate (SW)	8.469	27' - 9 3/8"
Winter (FW)	8.642	28' - 4 1/4"
Winter (SW)	8.432	27' - 8"

Self Unloading Equipment

Single belt gravity system with reclaiming machine and loop belt elevator. 78.1 m discharge boom luffing to 18° and slewing to 95° P&S. Designed discharge rate of up to 4,572 metric tons/hour.

Cargo Deadweight

(610 Tonnes consumables assumed)

	Metric	Long
MS (FW)	34,675	34,127
26'-6" (FW) Seaway Draft	28,803	28,348

Note: Deadweight shown **excludes** Crew & Effects, Fuel Oil, Lube Oil, Water & Stores (~610 MT).

Midship Air Draft

(To Top of Hatch Coaming at Side)

	Metres	Feet
Summer (FW) (9.017 m)	5.152	16' - 11"
Seaway (FW) (8.077m)	6.092	20' - 0"
Ballast (FW) (5.680 m)	8.489	27' - 10"

Hold Capacities

	m ³	ft ³
Total, hold and hatches	38,461	1,358,237

Hatches

Number: 22
Type: Single plate

	Metres	Feet
Bow to mid Hatch #1	25.60	84.00
Fwd to Aft	157.28	516.00
Mid Hatch #22 to Stern	39.62	130.00

63 Church Street Suite 600 St. Catharines, Ontario L2R
 3C4 Tel: 905.988.2600 Fax: 905.988.1801
www.algonet.com